

# digital digital

## LIVE ALTERNATIVE DRUM & BASS / ELECTRO PUNK

### TECHNICAL RIDER FOR FESTIVALS / UPDATED IN MAY 2021

>>> All questions via email only: [crew@alterfashion.net](mailto:crew@alterfashion.net) <<<



#### SOUND:

L-acoustic, EAW, d&b, Meyer Sound  
or similar 3-5 band premium sound system  
10-15 kW up to 500 persons  
15-20 kW up to 1000 persons  
30 kW and more for Open Airs



**We play VERY LOUD and work with professional stage equipment only!**  
**Minimal SPL 110 dB! 120dB is preferred! Mind the headroom**

#### ALL FOLLOWING STAFF WE NEED ON STAGE:

*NOTE! if it is some difficulties to provide of any following staff,  
please notify our band management in advance, we will find the solution, don't worry =)*

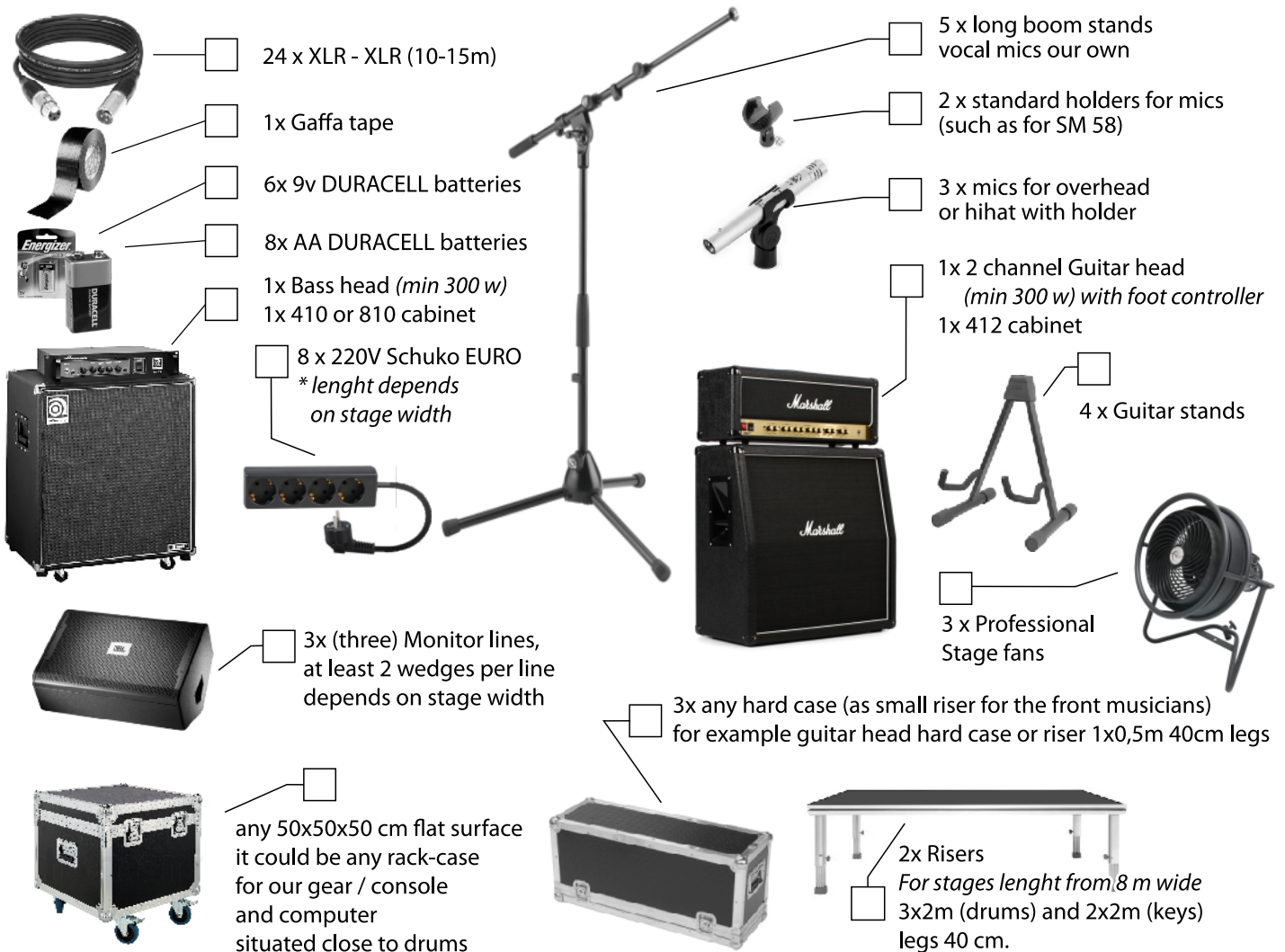

*\* no need for small stages* **page 1/3**

# DRUMS

Standard professional drumkit like: Tama, Yamaha, DW etc

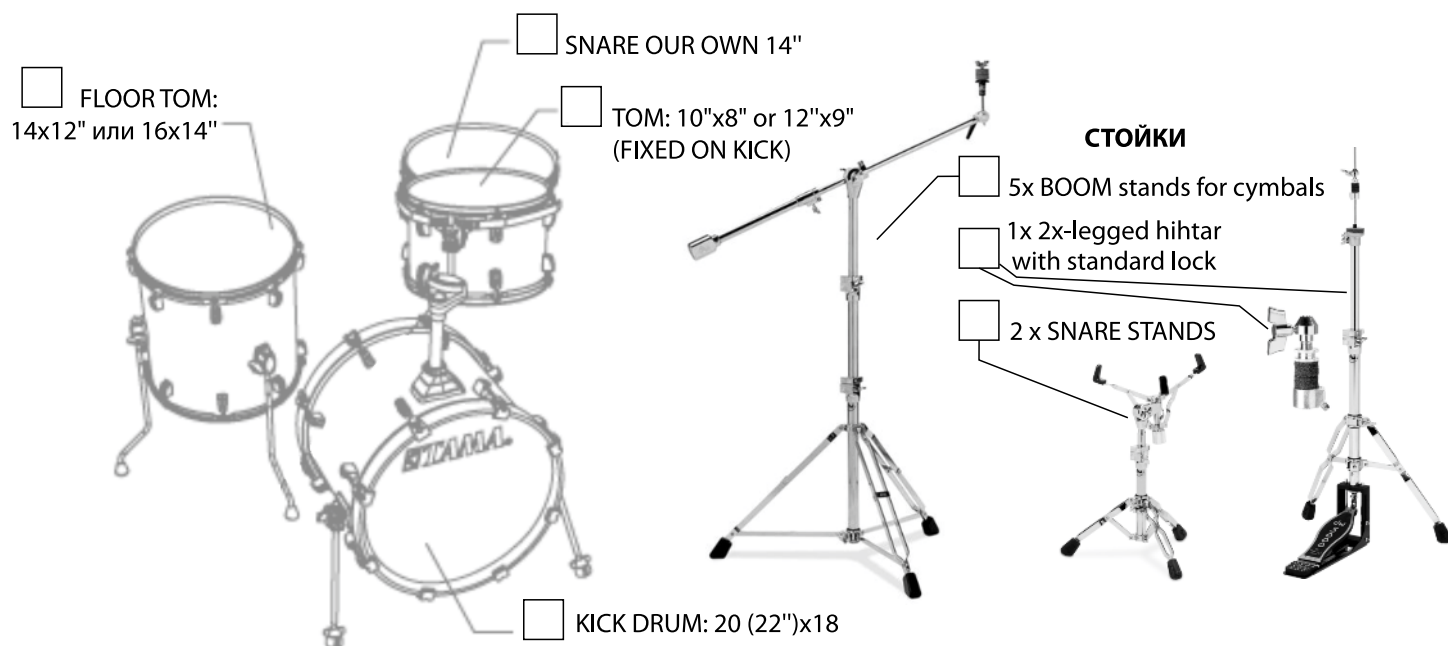

☐ 1x DRUM THRONE



☐ 1x CARPET (2 x 2 m)



**WE USE DDRUM TRIGGERS  
STANDARD METAL HOOPS  
NB! NOT FAT OR WOODEN ONES**



**\* IF WE TRAVEL BY PLANE TO AVOID OVERWEIGHT,  
PLEASE PROVIDE THE FOLLOWING STAFF**

- ☐ 1x SET OF ANY PREMIUM CYMBALS (preferable – Zildjian)  
Hi-hat 14 " / Crash 16 " / Crash 18 " / Ride 22 " (or 20 ") / China 16 " (or 18 ")
- ☐ 1x TAMA SPEED KOBRA DOUBLE PEDAL or equivalent



## THE BEST POSITION ON STAGE

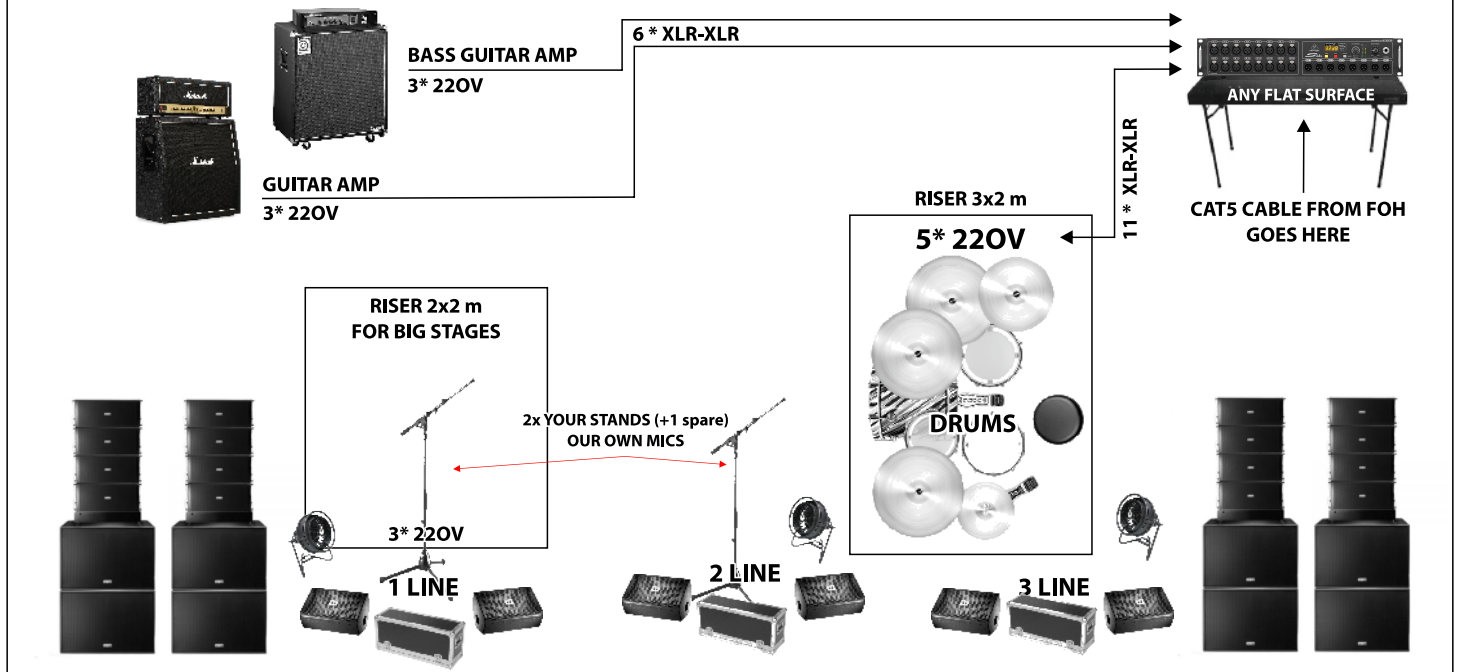

## 5 PERSONS ON STAGE

Drums positioned sideways as close to the edge of the stage as possible.  
Risers for guitar (2x2) and for drums (3x2) with 40 cm legs for big stages

**5 CHANNELS ON MAIN CONSOLE IS RESERVED FOR US ONLY!!!**

Soundcheck 2!!! (two) hours minimum. 1 hour check for festivals (with 1-2 stagehands) and 15 min line check

**LINE CHECK WITHOUT SOUNDCHECK IS IMPOSSIBLE!**

# FOH

**CAT 5 (Rj45)  
from FOH to STAGE**



**3\* 220V**  
**OUR X32 RACK + MAC**



Any top series DIGITAL console with 5 channels for us.  
Midas / Behringer / Yamaha / Allen&Heath / Soundcraft, Avid and so on

**CHANNEL LIST:**

1. RIGHT MIX  
2. LEFT MIX  
AUX 1 - MONITOR LINE 1  
AUX 2 - MONITOR LINE 1  
AUX 3 - MONITOR LINE 1  
SIDEFILLS: MASTER MIX

## VIDEO:

If there is LED screen or possibility of Projector on stage - We will use that.  
Video goes from our computer placed on stage or on FOH position (HDMI, VGA).  
Please prepare cable.

If you use Resolume Program, please let us know, we will send you .MOV file

**SOUND & LIGHT ENGINEERS:** Sound engineer always travels with us

**We also travel with our light guy with own console (please clarify that point!)**

**CONTACT INFO:** crew@alterfashion.net

VIBER / TELEGRAM / WHATSUP +372 58436000 (EST, ENG, RUS)