

# FICKLE VIBE

## technical rider

### INPUT LIST

Input No.	Source	Microphone/D.I.	Stand
1	Bass drum	AKG D12	Low stand
2	Snare top	Shure SM57	Mid stand/clips
3	Snare bottom	Shure SM57	Mid stand/clips
4	Hi-hat	KM184, SM81, RodeNT5	Mid stand
5	Rack Tom	Sennheiser E904	Clips
6	Floor Tom	Sennheiser E904	Clips
7	Over Head R	AKG C414/C214	High Stand
8	Over Head L	AKG C414/C214	High Stand
9	Loop L	D.I.	
10	Loop R	D.I.	
11	Bass Gtr.	D.I.	
12	Novation Bass Station	D.I.	
13	El. Guitar 1	SM57	Mid Stand
14	El. Guitar 2	SM57	Mid Stand
15	Waldorf Blofeld L	D.I.	
16	Waldorf Blofeld R	D.I.	
17	Nord Lead L	D.I.	
18	Nord Lead R	D.I.	
19	Voc FX L	D.I.	
20	Voc FX R	D.I.	
21	Voc	Shure Beta58	High Stand

## STAGE PLOT

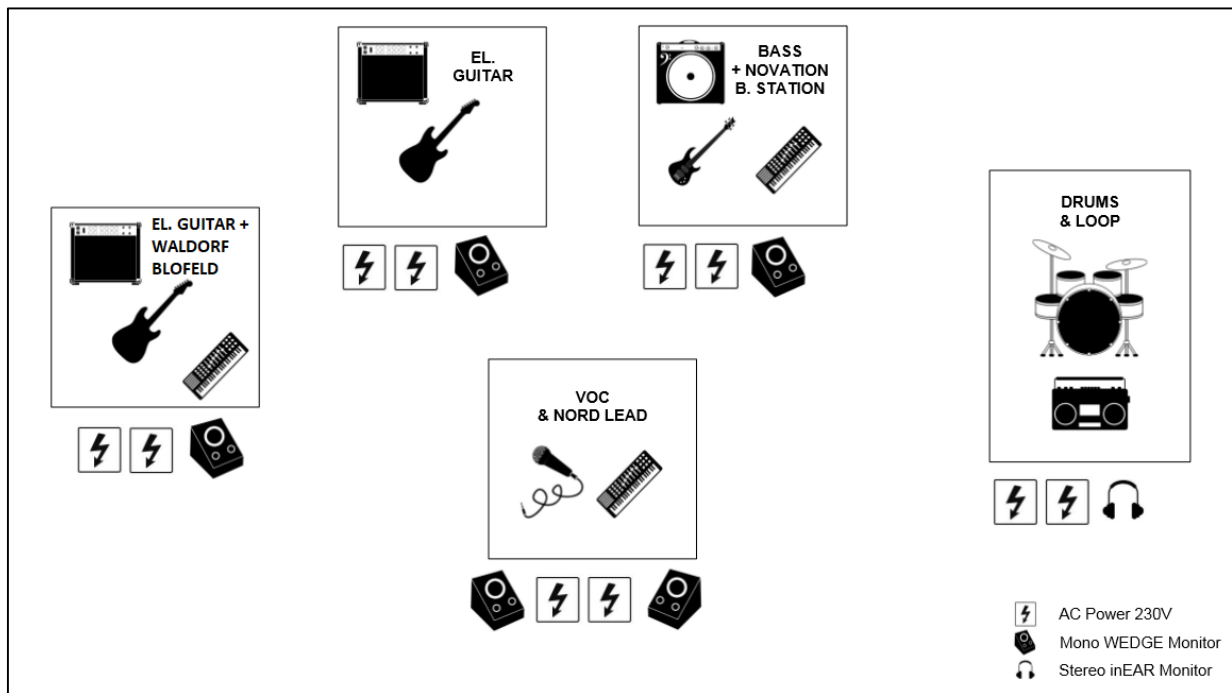

We need a digital mixing console with at least 24 input channels. We prefer Behringer X32 console configured with external wi-fi router for X32-Mix App controlling.

Each of us requires an independent mono monitor bus except drummer. He uses a wired stereo in ear monitor and 2x XLR output from stereo bus is needed.

In case of any questions feel free to contact:

Tomasz Maciejewski

Tel.: 0048 663659065

e-mail.: [maciejewski.tk@gmail.com](mailto:maciejewski.tk@gmail.com)

*Technical rider last update: 07.11.2019*