

MAKIA Stagerider

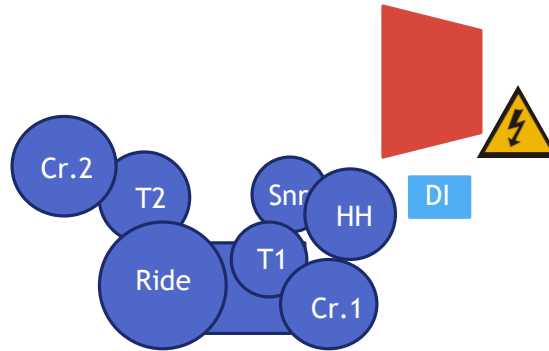

Amp Bass

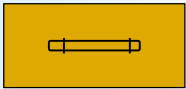

EFFEKT-XLR



Amp GTR

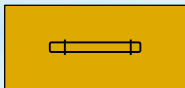

CONGAS

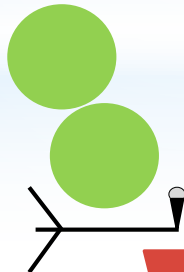

Amp GTR

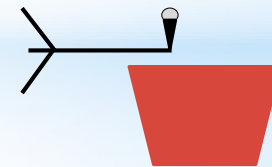
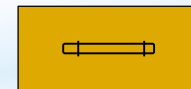

MAKIA Stagerider

NUMBER	INST.	MIC
1	Kick	AKG D112 / Shure BETA 91 / Shure BETA 52
2	Snare Top	E 604 / Shure SM 57
3	Snare Bottom	Shure SM 57
4	Hi Hat	Shure SM 57
5	Tom 1	Shure BETA 57 / Shure SM 57
6	Tom 2	Shure BETA 57 / Shure SM 57
7	OH Drums L.	Shure SM 81 / Neumann KM180
8	OH Drums R.	Shure SM 81 / Neumann KM180
9	Sample Pad Drums	DI BOX
10	Conga Low	Rode NT5 / Shure SM 57
11	Conga High	Rode NT5 / Shure SM 57
12	Bass Mic	Shure SM 57
13	Bass Line	DI BOX
14	E Guitar	Shure SM 57 / Sennheiser MD421
15	E Guitar	Shure SM 57 / Sennheiser MD421
16	Saxophone	Clip Mic: DPA D 4099T / E 908 B / TG 152
17	Trumpet	Clip Mic: DPA D 4099T / E 908 B / TG 152
18	Effekt-Trp.	XLR
19	Voc-Front	Wireless Mic: Shure GLXD24/SM58 Sennheiser EW D1 845
20	Voc-Guitar	E 835 / SM 58
21	Voc-Saxophone	E 835 / SM 58

